

TECHNICAL SPECIFICATION

LED Downlights RDLOMCOB



Technical data

- Power: 10W; 20W
- Colour temperature: 4000-4300K; 2700-3000K • Rated voltage: 230V / 50/60Hz
- Lumens /whole fixture/:
 - 10W – 800lm
 - 20W – 1600lm
- Power Supply: control gear, DC device – driver, included in the set
- LED type: COB
- Light source Epistar Taiwan
- Colour rendering index: Ra≥80
- Switch on/off > 20000
- Protection against dust and moisture: IP40
- Housing: aluminum
- Colour of the housing: white; silver
- Mounting: surface
- Long life: 30000 hours
- Beam angle: 60°
- Power factor: $\lambda > 0.9$

Areas of application

- Commercial buildings
- Administrative buildings
- Residential buildings
- Banks
- Hospitals
- Schools
- Entertainment and leisure spots

Product benefits

- Completely replace traditional lighting fixtures
- Pleasant and uniform light distribution
- Low power consumption
- Repeated switch on/off does not affect the lifespan
- Instant light with maximum luminous flux
- Environmentally friendly - no mercury and lead
- No ultraviolet and infrared rays
- Resistant to shock and vibration-free body
- Low heat emission

Variants and dimensions

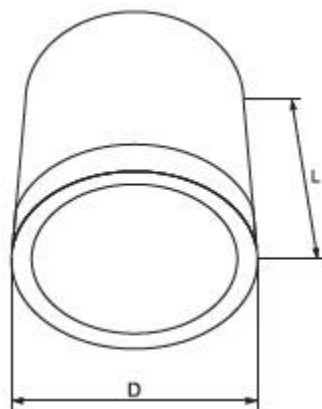

Watt	LED chip lumens (lm)	Whole fixture lumens (lm)	Colour temp. (K)	Colour body	Size		Catalogue number	Packing (pcs)
					D	L		
10W	1200	800	4000-4300	white	95	70	92DLOM1040/WH	24
10W	1200	800	2700-3000	white	95	70	92DLOM1027/WH	24
10W	1200	800	4000-4300	silver	95	70	92DLOM1040/S	24
10W	1200	800	2700-3000	silver	95	70	92DLOM1027/S	24
20W	2400	1600	4000-4300	white	95	110	92DLOM2040/WH	12
20W	2400	1600	2700-3000	white	95	110	92DLOM2027/WH	12
20W	2400	1600	4000-4300	silver	95	110	92DLOM2040/S	12
20W	2400	1600	2700-3000	silver	95	110	92DLOM2027/S	12

Luminous distribution curves

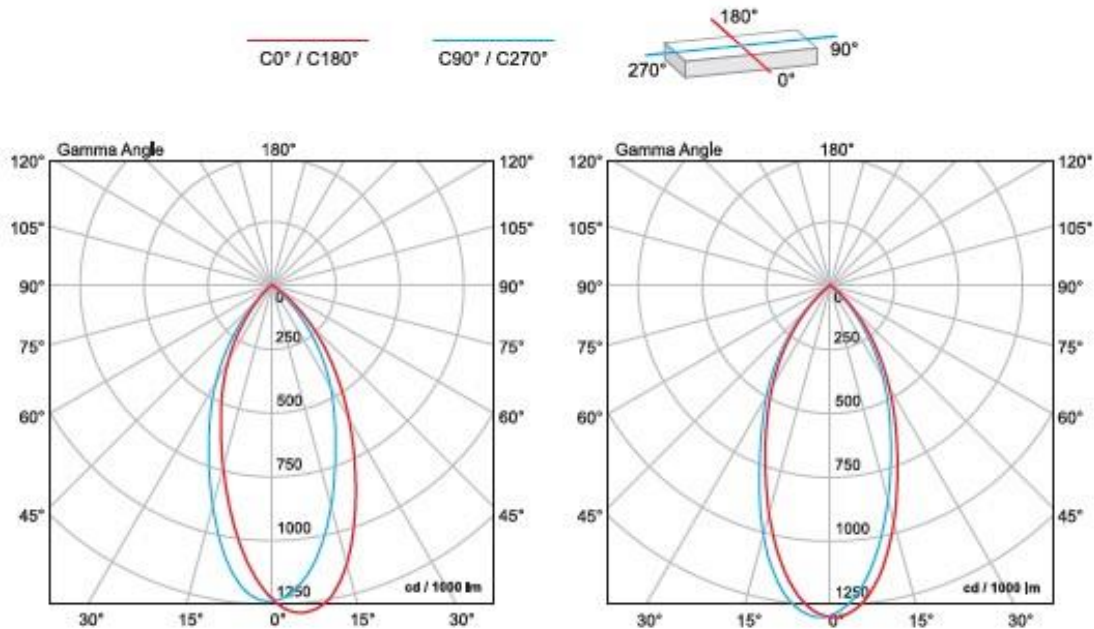

Energy efficiency

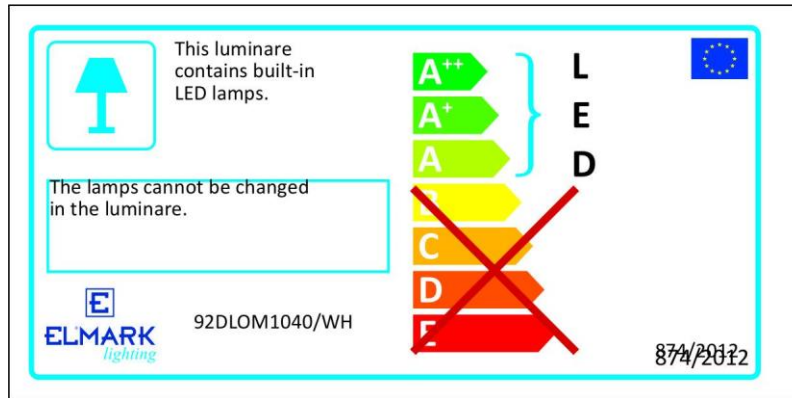

Barcode

Barcode	Catalogue number
3800131187000	
3800131187017	92DLOM1027/WH
3800131187024	92DLOM2040/WH
3800131187031	92DLOM2027/WH
3800131187048	92DLOM1040/S
3800131187055	92DLOM1027/S
3800131187062	92DLOM2040/S
3800131187079	92DLOM2027/S

Standards

EN 55015 EN 61000-3-2; EN
61000-3-3 EN 61547

EN 60598-1; EN 60598-2-2

